

**Pacta**  
***SALICE***

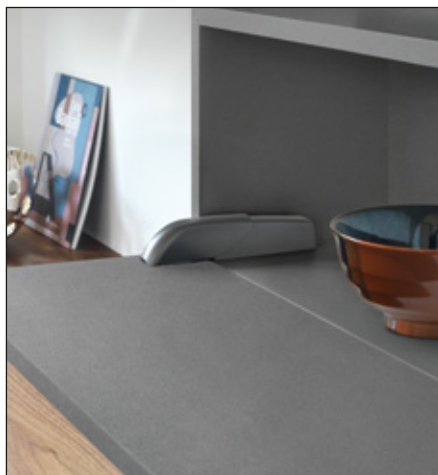

Pacta is a compact hinge for fall flaps which operates without the need for additional stays or cables.

Pacta confers a decelerated opening action and the fall of the door is gradual and controlled.

In the fully-open position, the door and base panel are aligned, creating a uniform and flat surface.

Available with Push self-opening system, Pacta comes in a variety of finishes. Its applications are numerous: in living room and kitchen cabinets, to create desks in children's furniture or for writing surfaces and table extensions in hotel furniture.

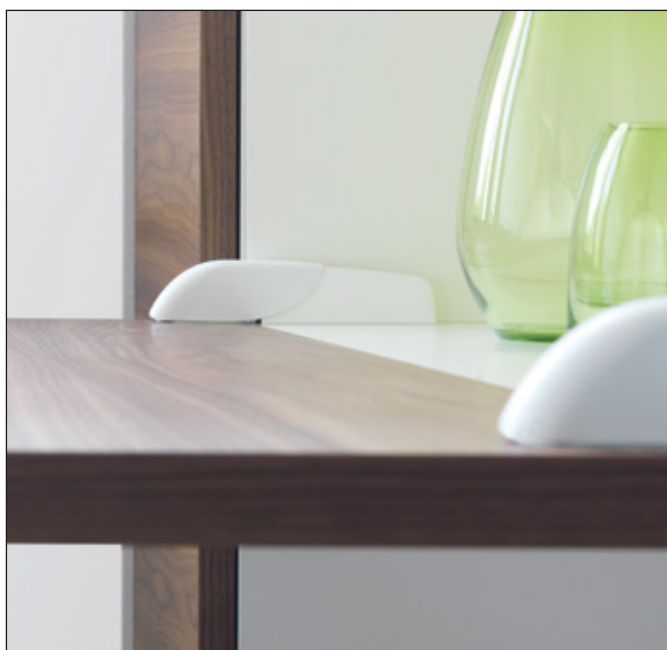

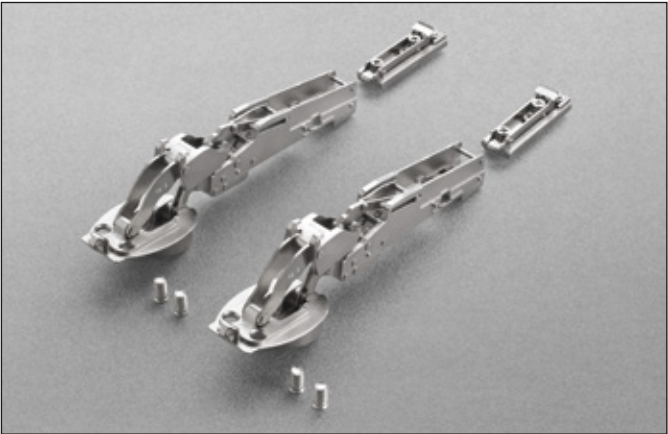

Technical information

Hinge for flap doors with decelerated opening.  
Sprung closing action.

Fixing to the base of the cabinet with longitudinal snap-on mounting plate (BAPGR29/16).  
Standard drilling of the door  $\varnothing$  35.  
13 mm deep cup.  
90° opening.  
Fixed K = 4.5 mm.

Pacta is tested and certified to level 3 of UNI EN 15828:2010

Drilling patterns

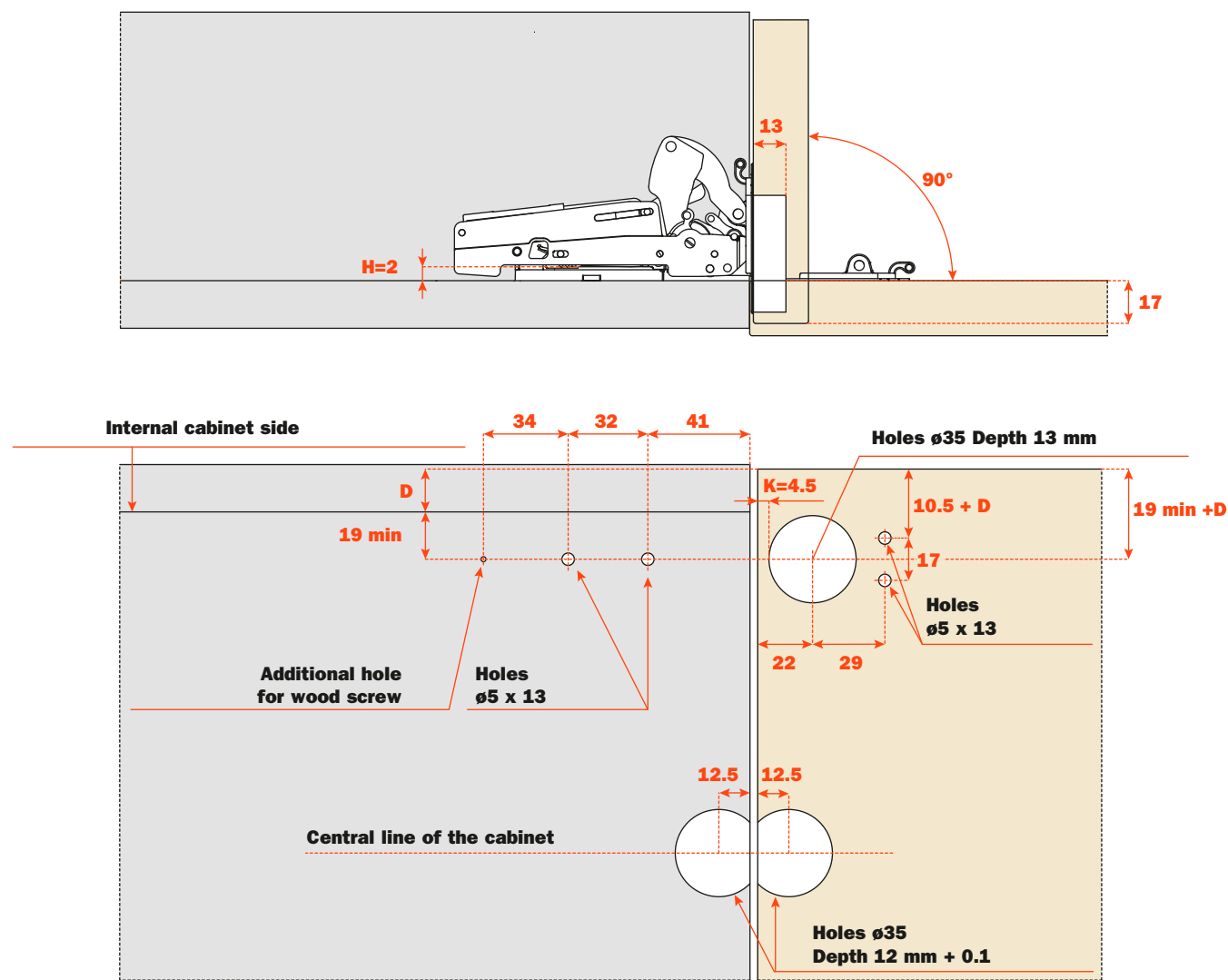

Space needed to open the door

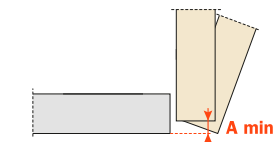

	T=	16	17	18	19	20	21	22	23	24	25	26	27	28
K=4.5	A=	1.3	2.1	3	3.9	4.8	5.7	6.6	7.5	8.5	9.4	10.4	11.3	12.3

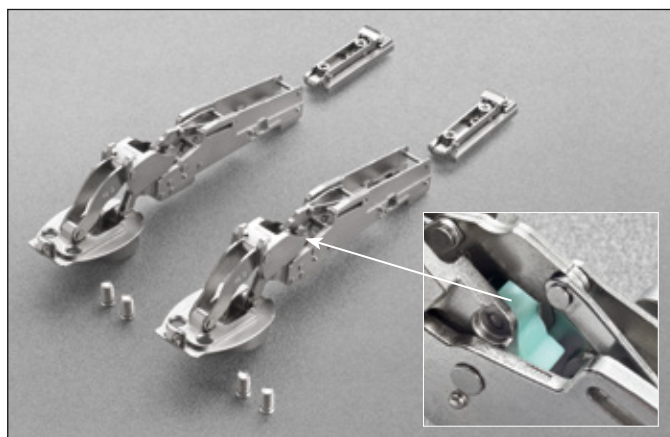

## Technical information

### Hinge for flap doors with decelerated opening. Push opening.

Fixing to the base of the cabinet with longitudinal snap-on mounting plate (BAPGR29/16).  
Standard drilling of the door  $\varnothing 35$ .  
13 mm deep cup.  
90° opening.  
Fixed  $K = 4.5$  mm.

**Pacta is tested and certified to level 3 of UNI EN 15828:2010**

## Drilling patterns

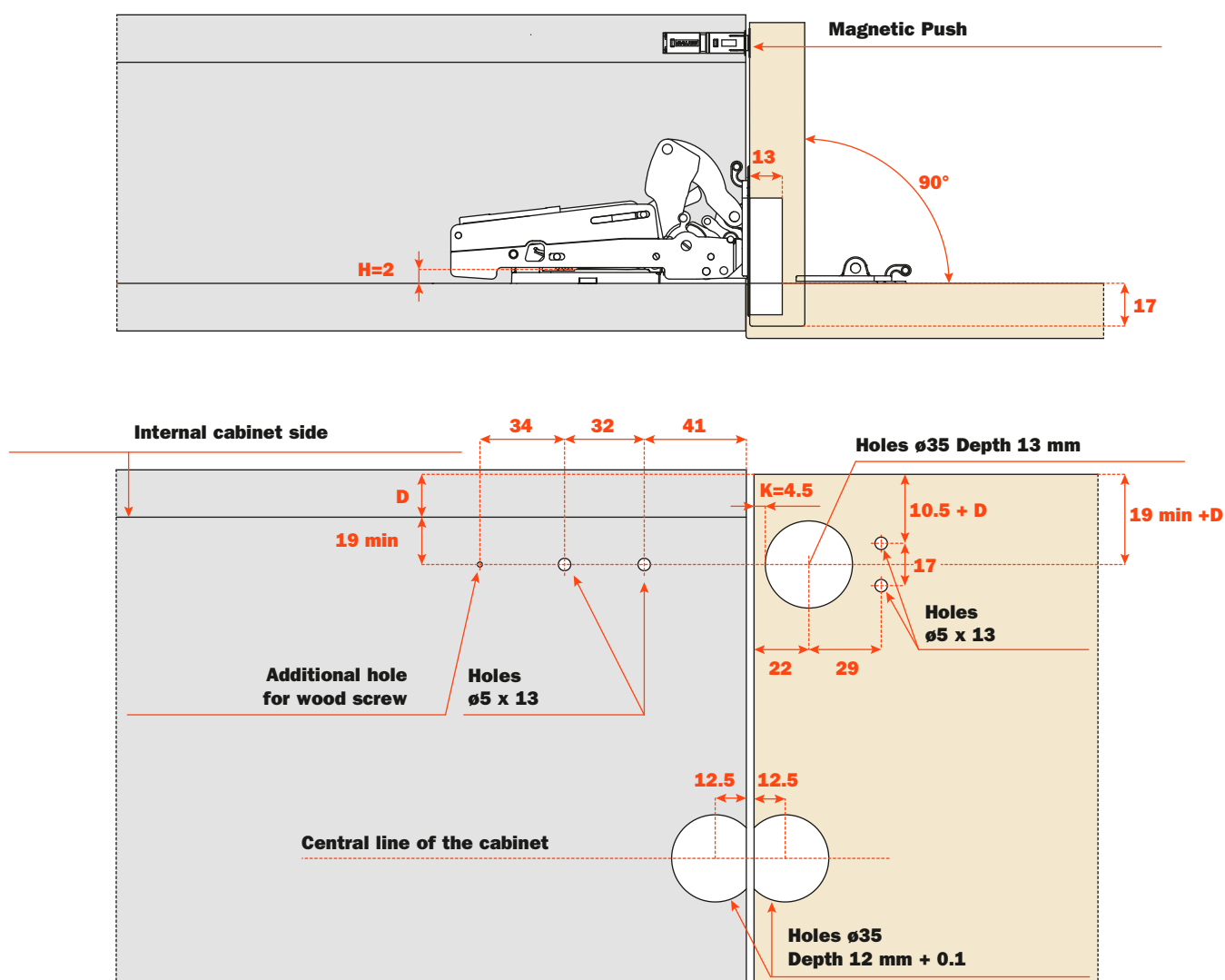

## Space needed to open the door

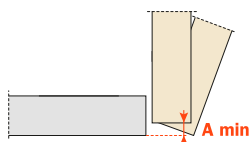

T=	16	17	18	19	20	21	22	23	24	25	26	27	28
K=4.5 A=	1.3	2.1	3	3.9	4.8	5.7	6.6	7.5	8.5	9.4	10.4	11.3	12.3

**Fixing the mounting plate to the cabinet**

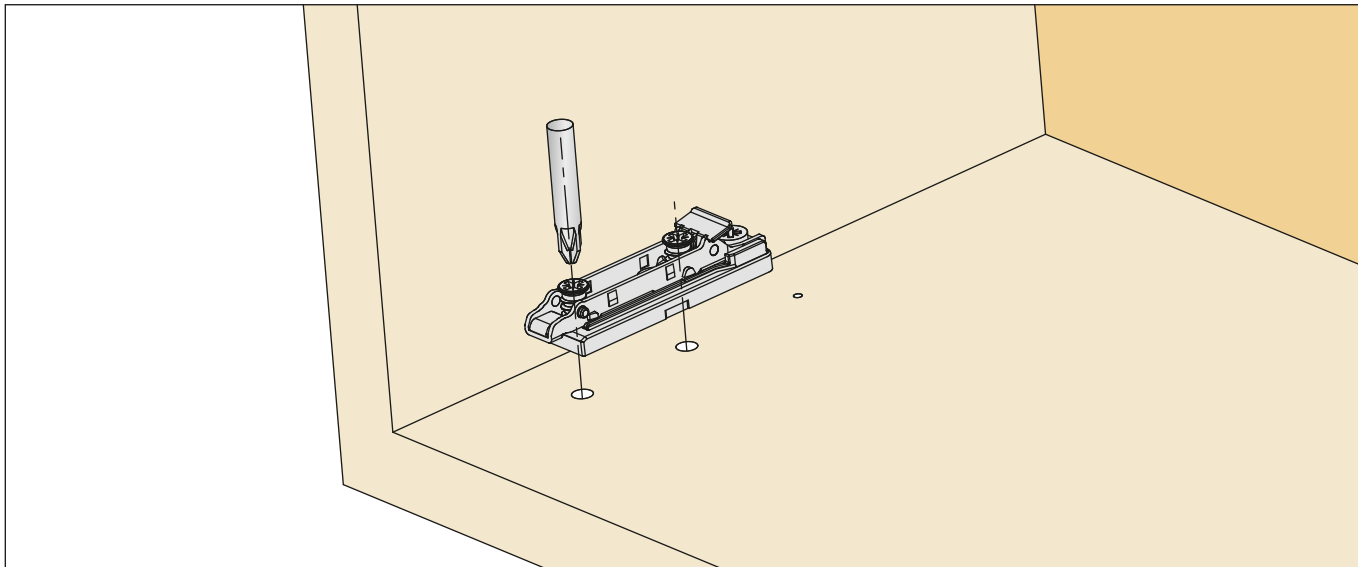

**Fixing the hinge to the door**

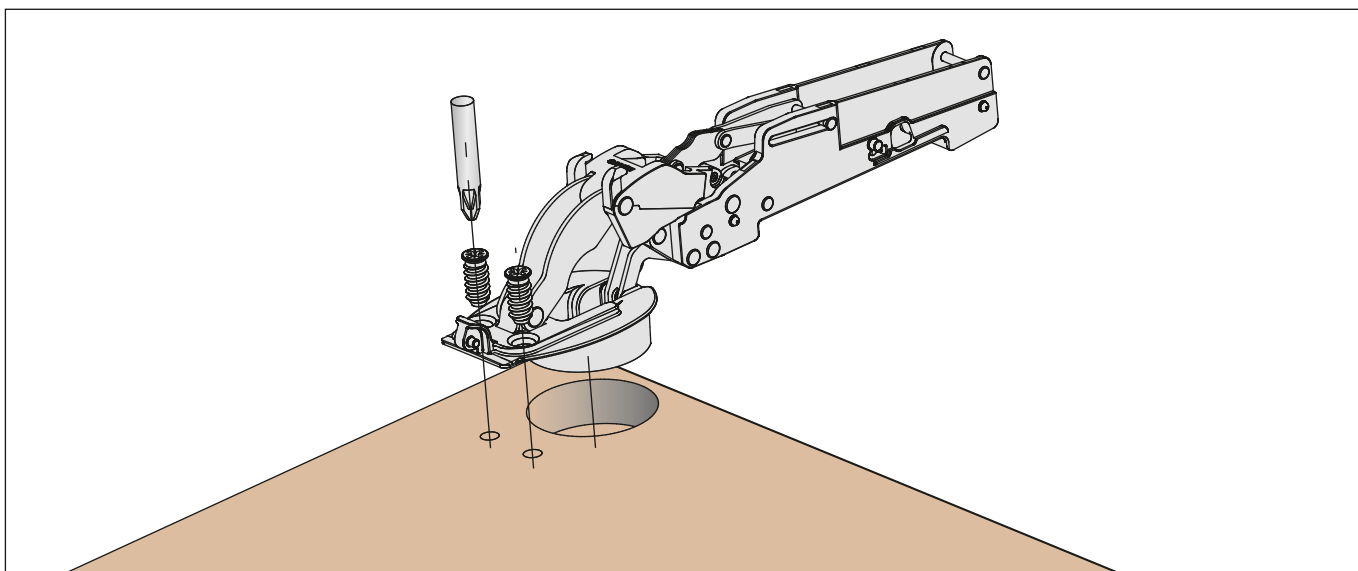

**Mounting the door onto the cabinet**

Clip the hinge arm onto the mounting plates. This operation is tool free.

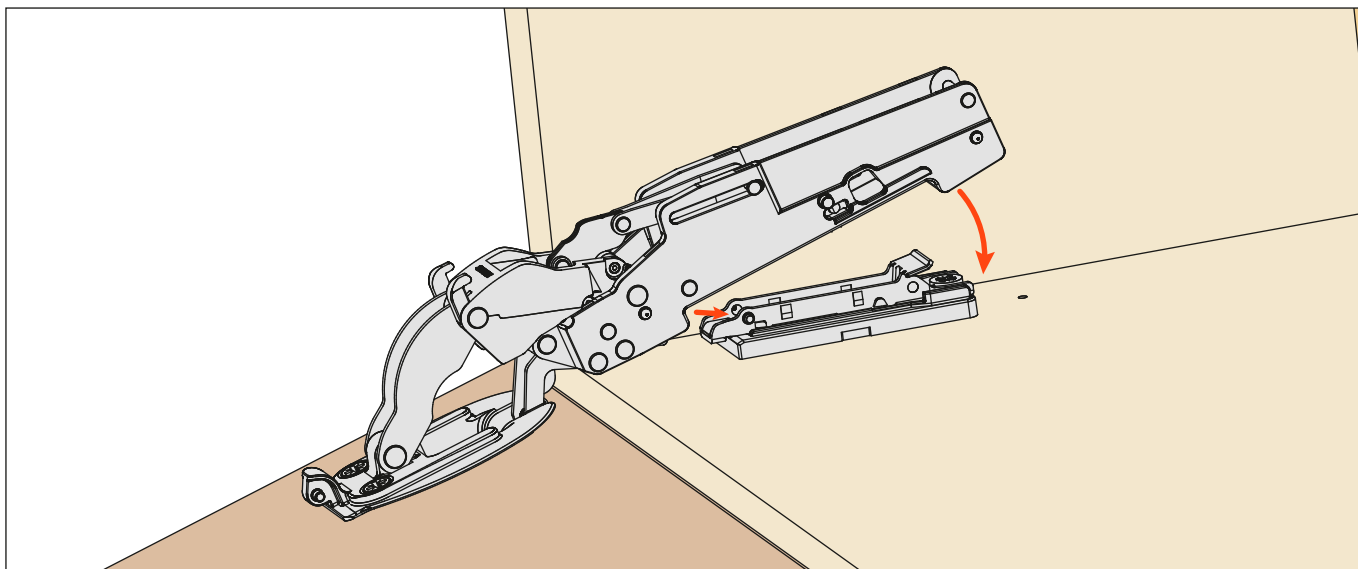

## Adjustments

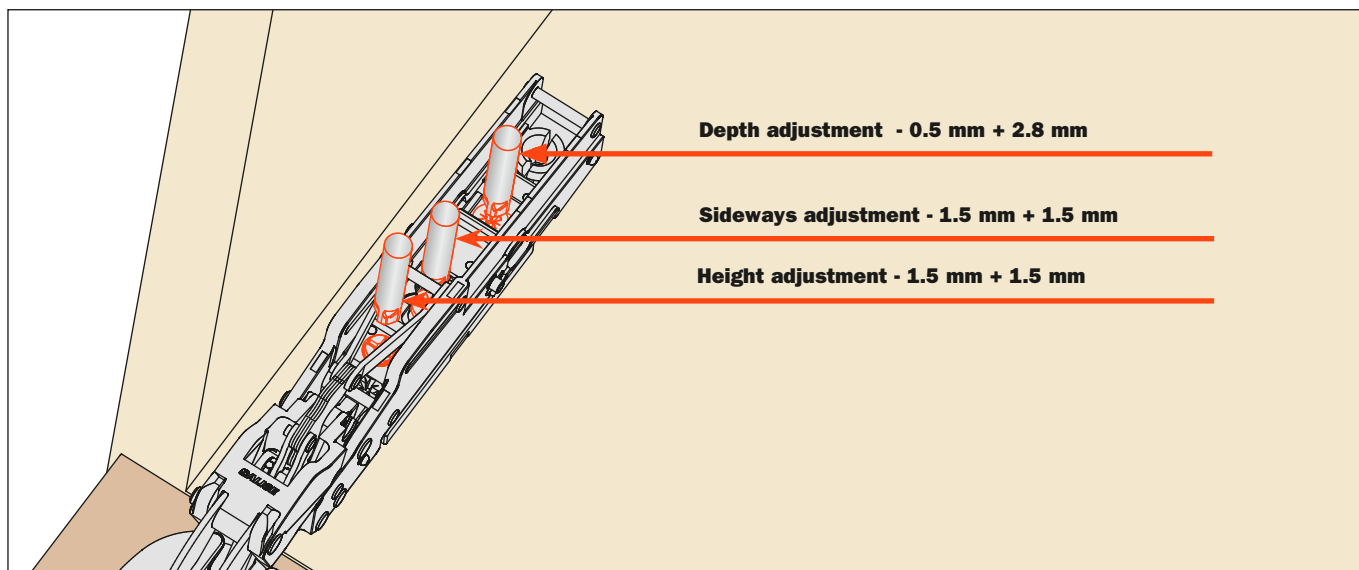

## Fix the security screw

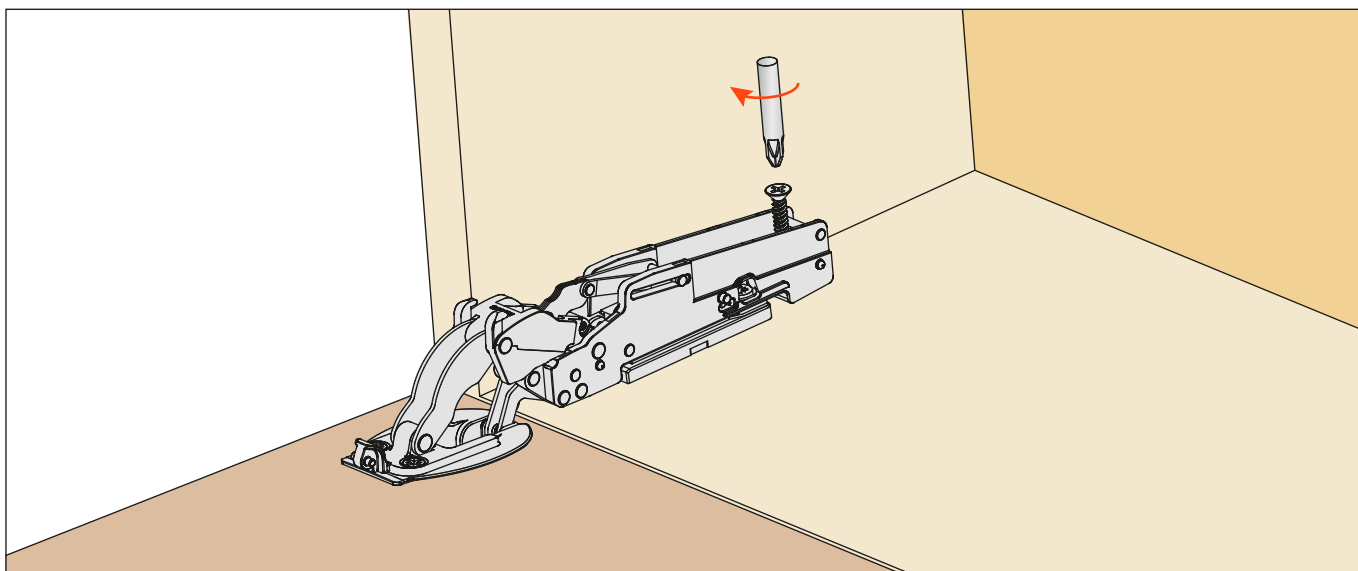

## Installing the Smove

Clip the narrow end of the Smove into position. This operation is tool free.

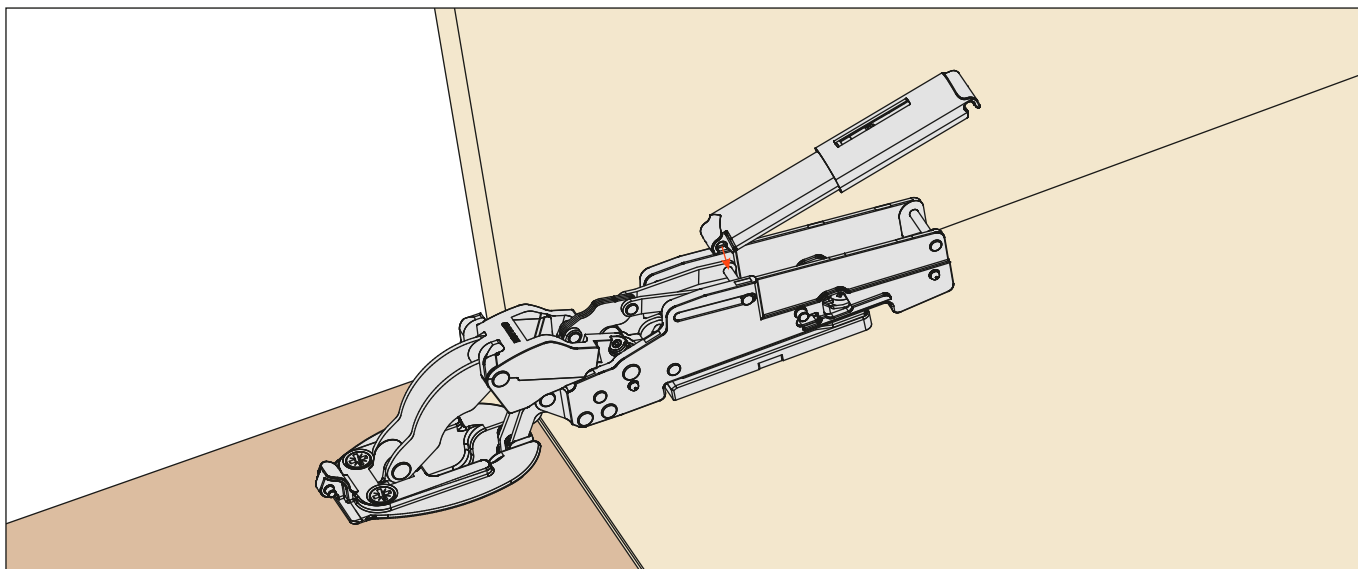

Lift the flap slightly and clip the other end of the Smove into position. This operation is tool free.

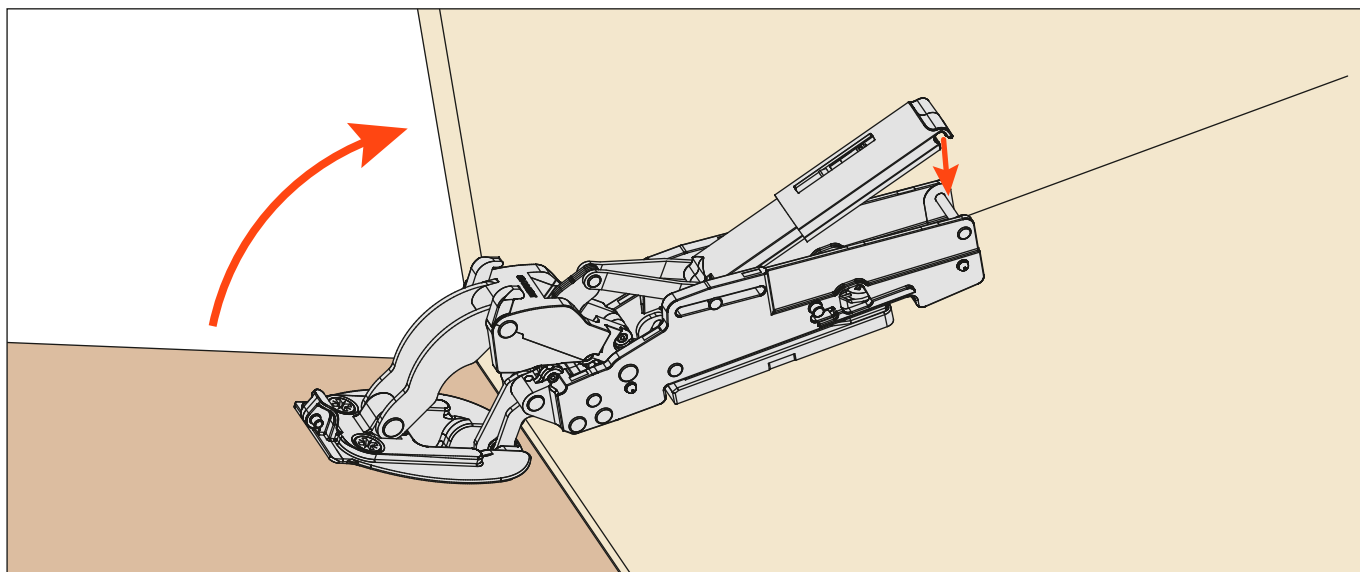

### Installing the cover

Firstly install the cover on the hinge arm and then to the cup.

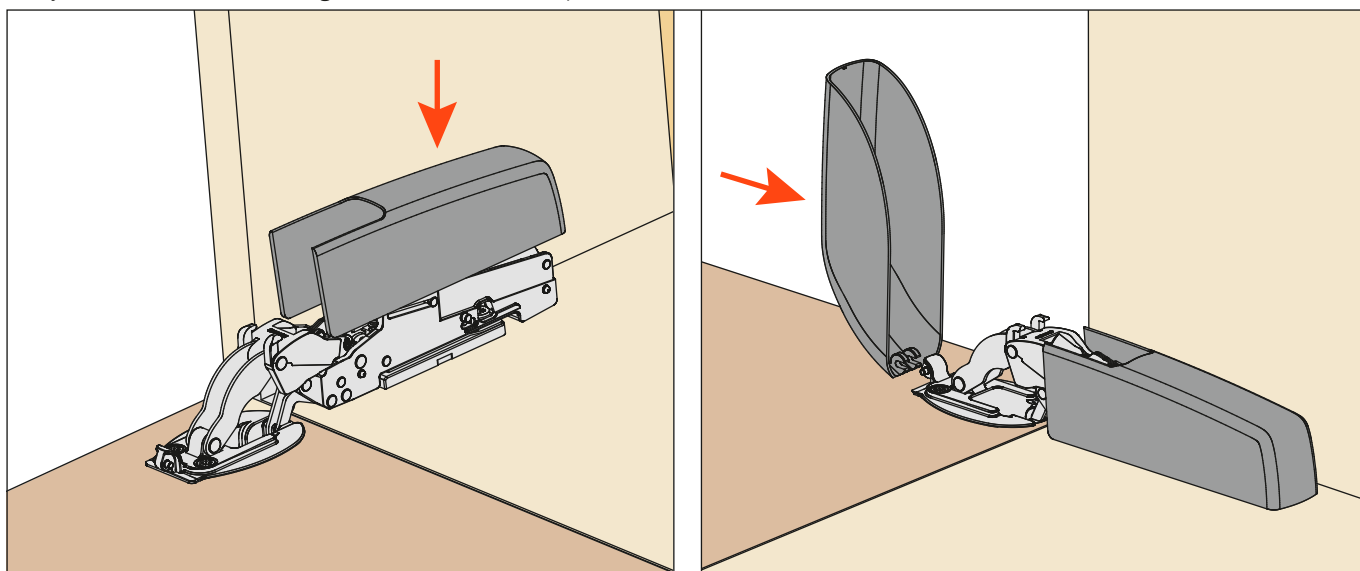

### Dimensions

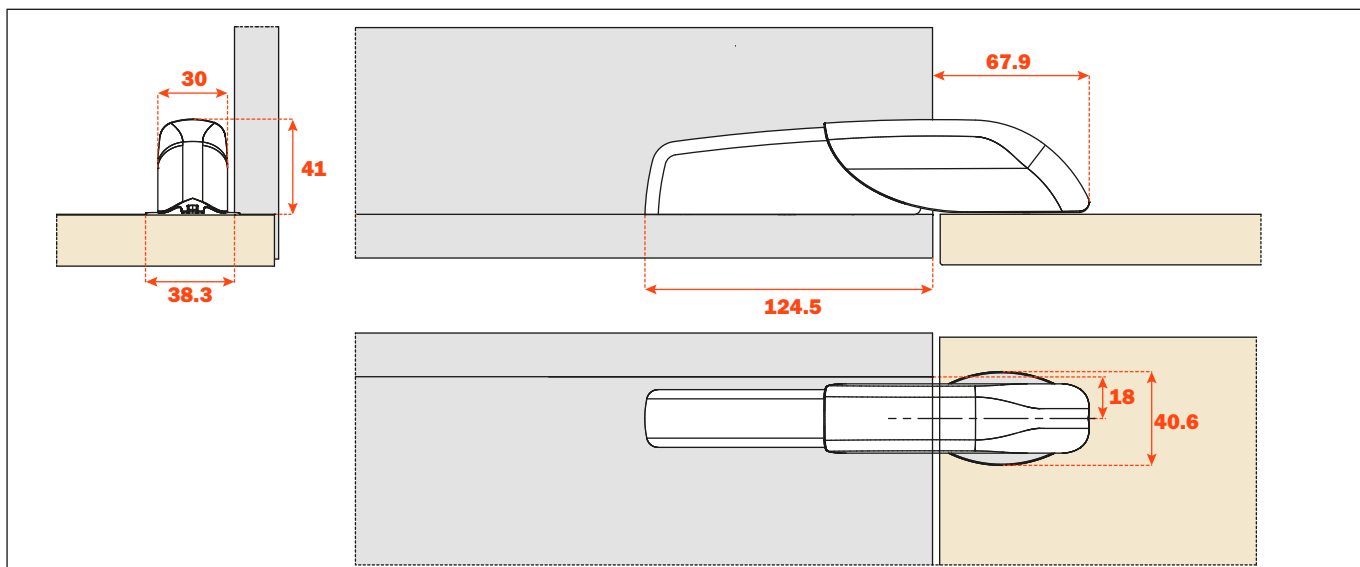



### Removal of the cover

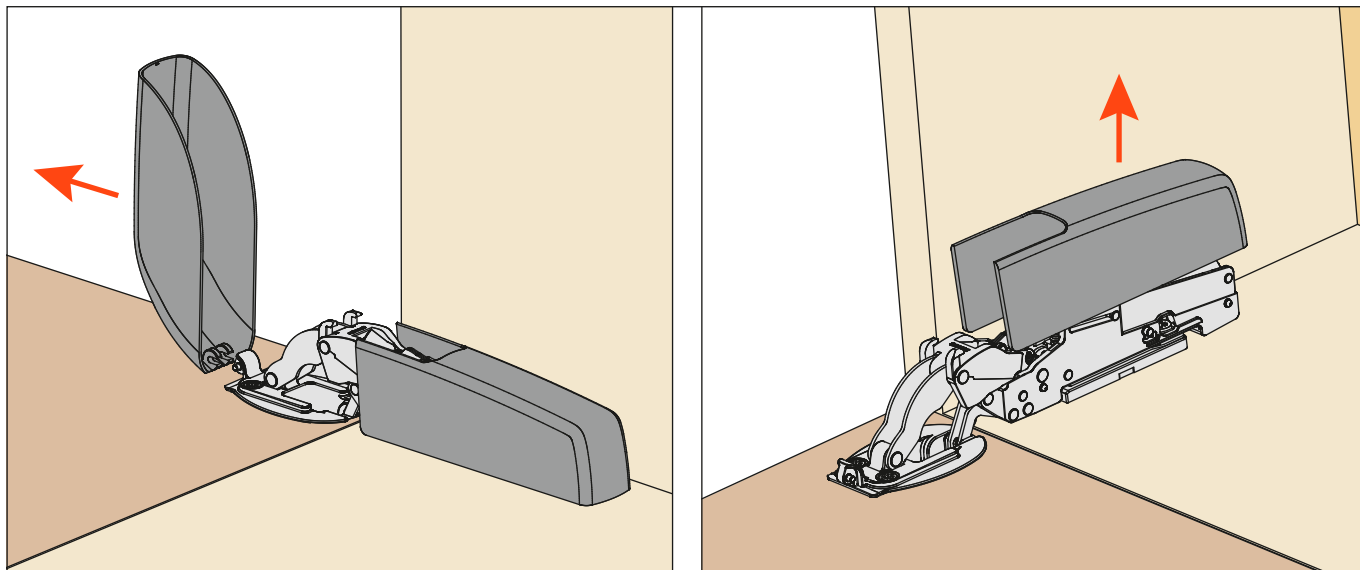

### Disassembly of the Smove

Lift the flap slightly and unclip the back of the Smove using a screwdriver.

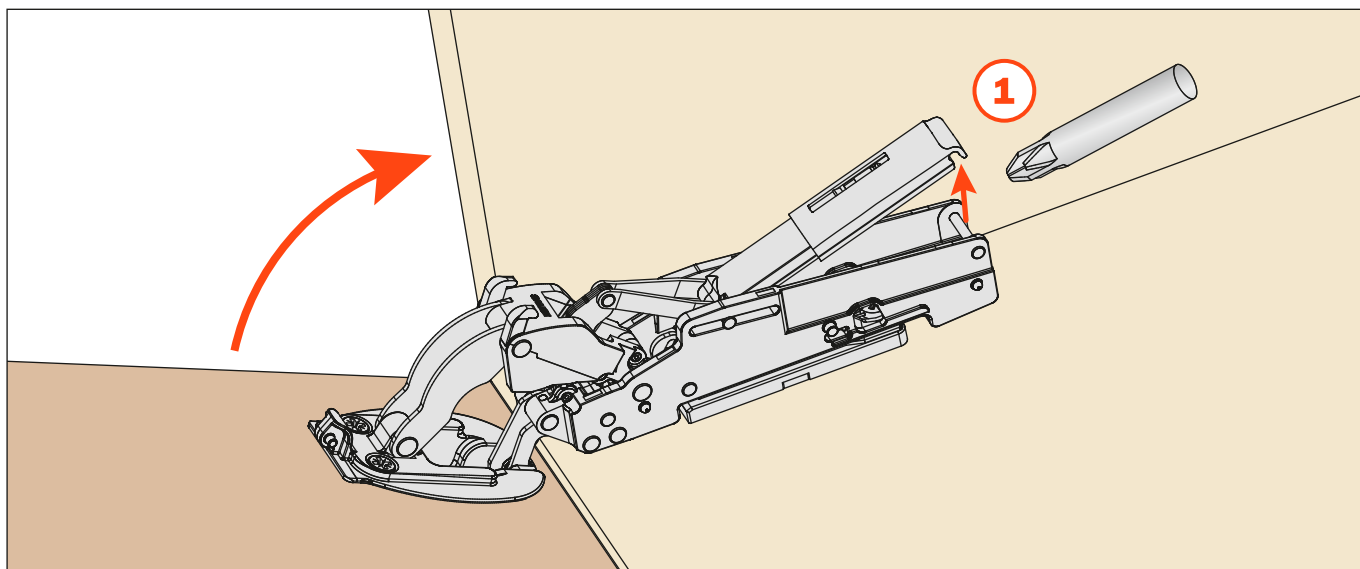

Remove the other end of the Smove.

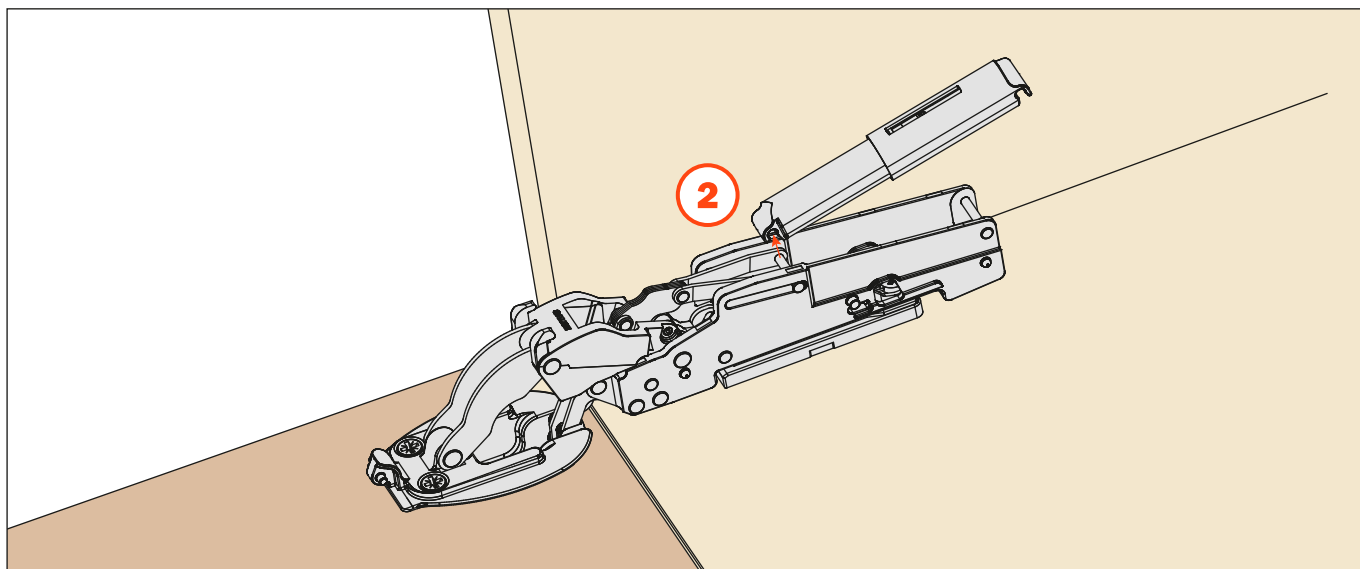



### Remove the security screw

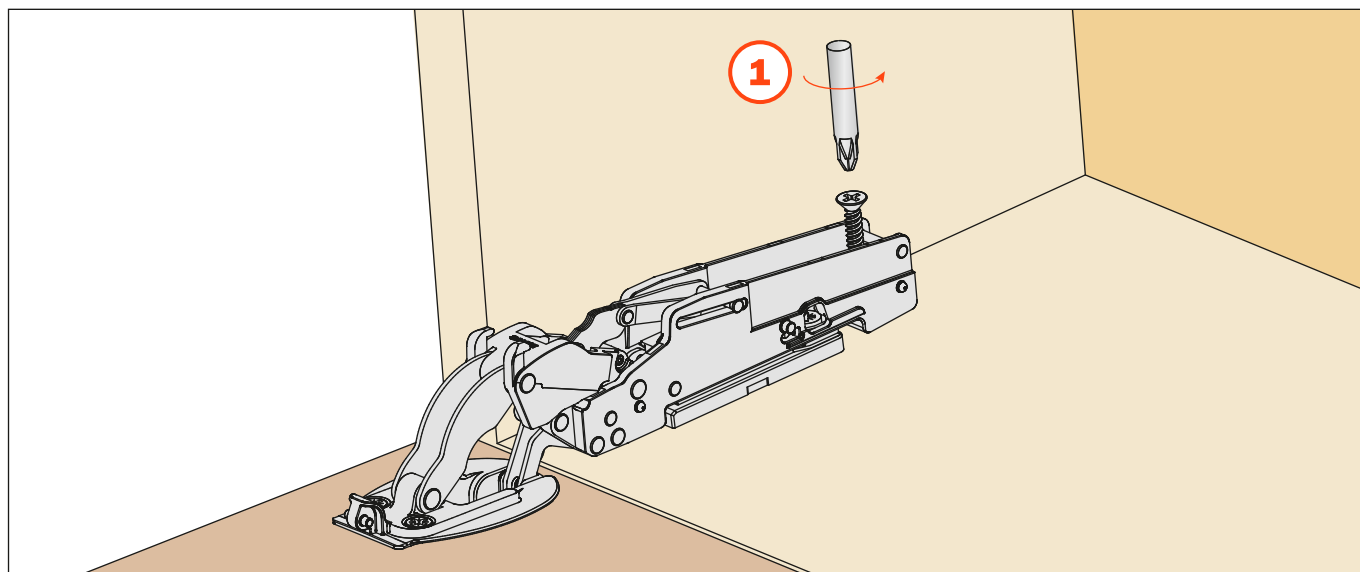

### Unfasten the hinge from the mounting plate with a screwdriver

