

ATLAS SYSTEM

For large suspended low furniture

- > The perfect solution for heavy loads in suspended kitchens and bathroom cabinets.
- > Easy industrial installation, can be preassembled to ease transport.
- > Maximum safety in the vertical loads, anti-tilt, easy machining and regulation and regulation.
- > In combination with the lower support fitting, the furniture can be adjusted in depth, vertically and horizontally.
- > Does not interfere with the smooth running of the top drawers.
- > Nominal capacity of 100kgs. per hanger. EN 15939 on B setting (60kg on C setting).





MAIN ADVANTAGES OF THE PRODUCT

INDAUX has developed ATLAS fitting device, as an answer to the technical challenges that the new suspended kitchens present. Traditional furniture fixing devices are not suitable for this trend, as are designed for cabinets with little depth and without drawers.

- > Hidden wall fixing system which adjusts perfectly to the module.
- > Easy industrial installation, can be preassembled to ease transport.
- > In combination with the lower support fitting, it can be adjusted in depth, vertically and horizontally

> The ATLAS system does not interfere with the smooth running of the top drawers.

> Nominal capacity of 100kgs. per hanger. EN 15939 on B setting (60kg on C setting).

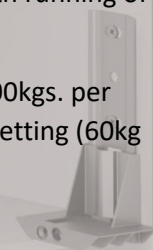

Back support fitting and wall plate

Back support fitting

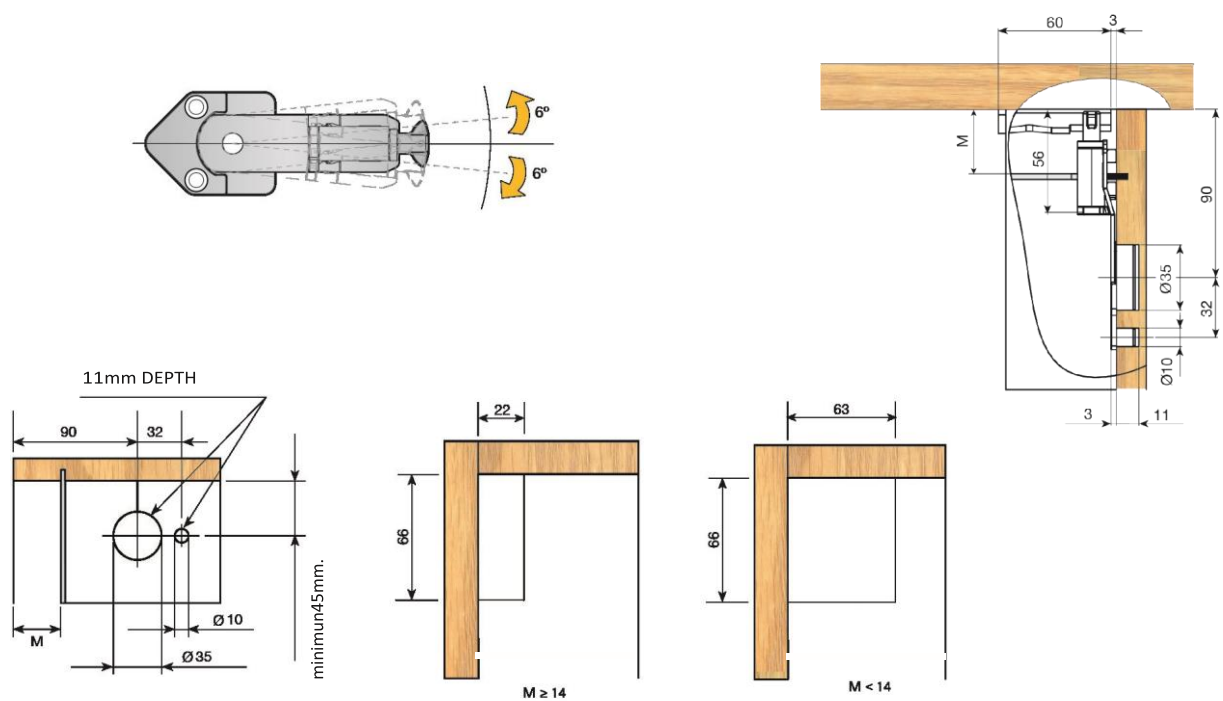
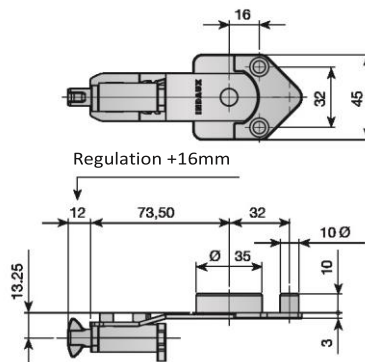

Wall plate

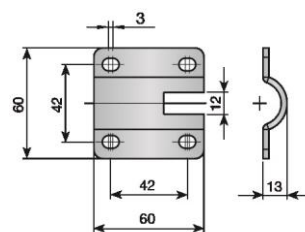

Lower support fitting

Lower support fitting 32mm

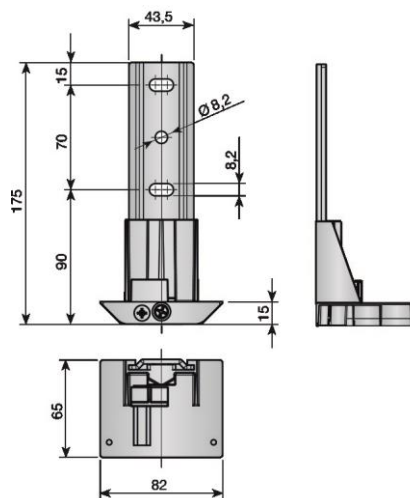

Lower support fitting 0 mm

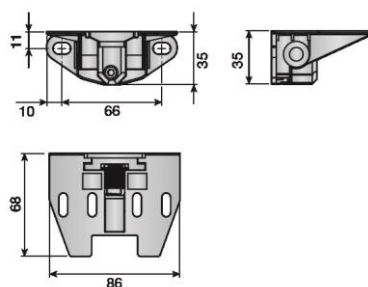

Lower supports selection guide

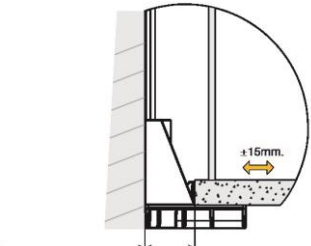
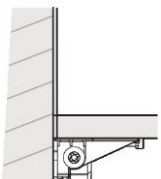
Lower support fitting		Adjustments	
		Frontal (horizontal)	Vertical
32 mm.	 <p>Min. 32 mm. Max. 62 mm.</p>	+ - 15 mm.	+ - 10 mm.
0 mm.		—	+ - 5 mm.

Technical data

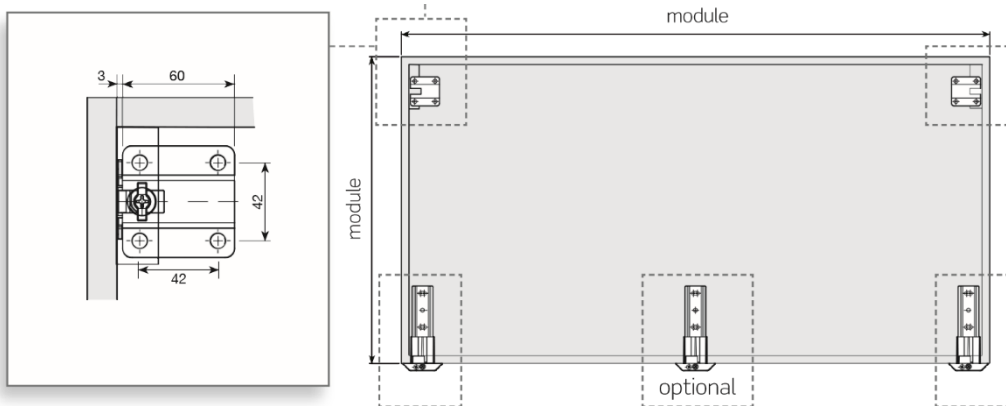

Lower support fitting 32 mm.

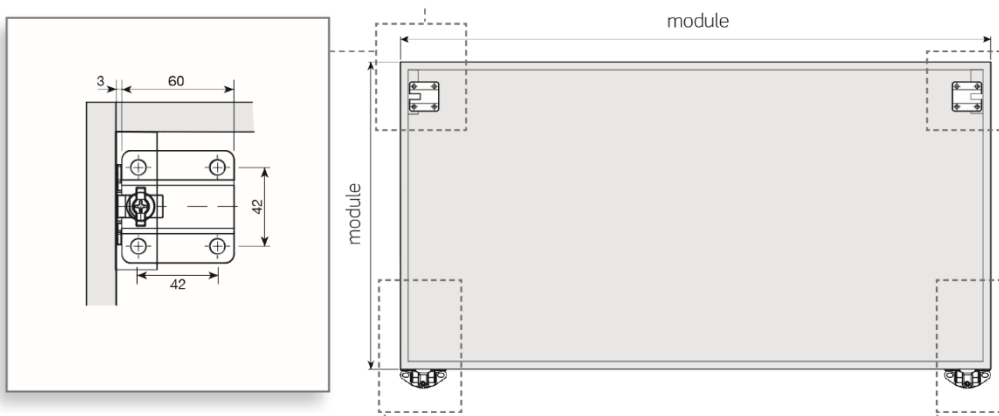
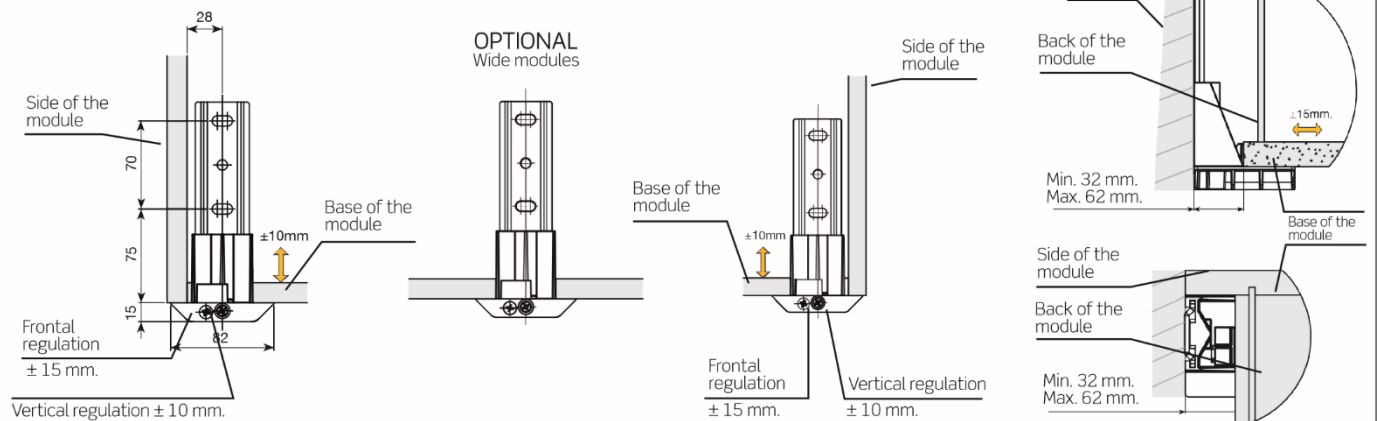

Lower support fitting 0 mm.

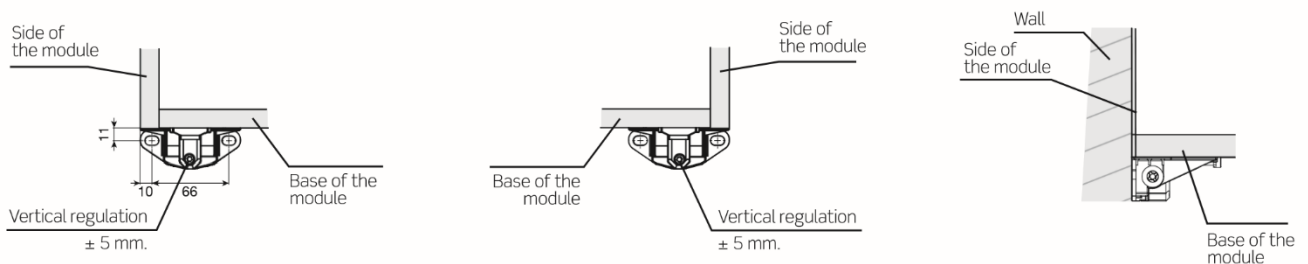

Assembly and adjustment

Example using lower support fitting 32mm.



B

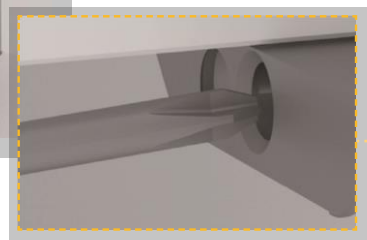
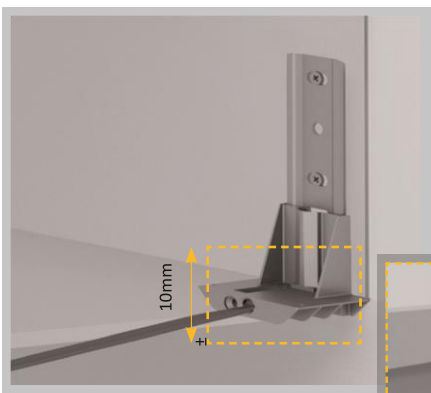

No previous machining of the module required before fixing the lower support.

Assembly and adjustment

A

